

VSA 300 S

The current version of the installation and operating instructions is available in the Download Center:



<http://qr.duerdental.com/9000-606-31>



Ambient temperature



Upper limit of humidity



Only qualified specialists or employees trained by Dürr Dental are permitted to install, connect and start using the unit.

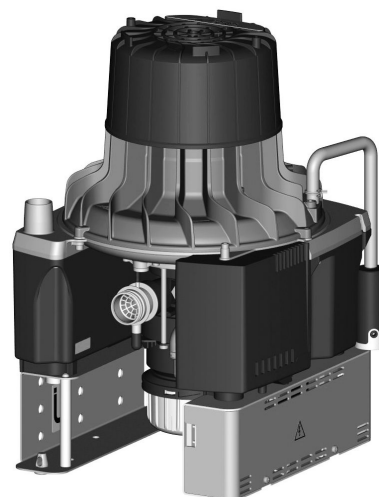

Assembly

1

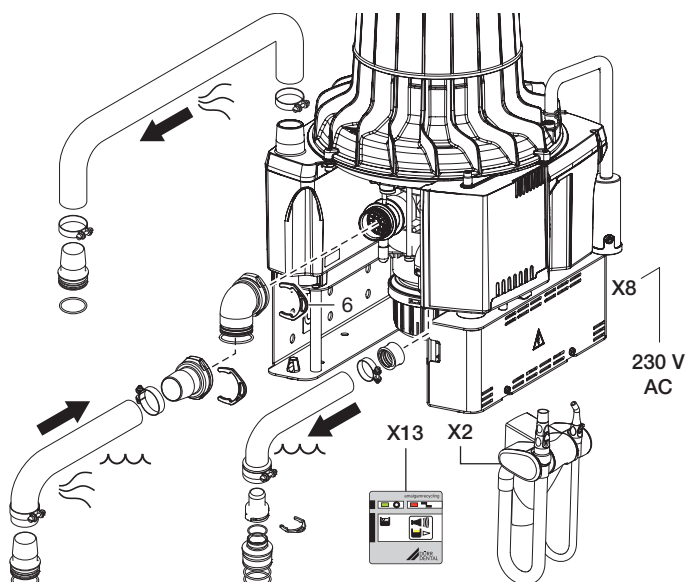

2



► Use advantages and profit with security. Register your product now!

Usage

Disinfection and cleaning

1

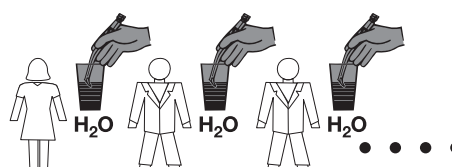

2

1x / Day
in the evenings

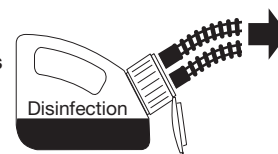

1x / Week
about noon

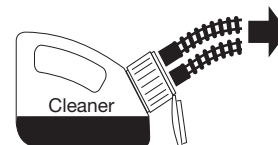

Cleaning the protective strainer

1

1.	2.	3.	4.	1.	
----	----	----	----	----	--

Woche / week



1.

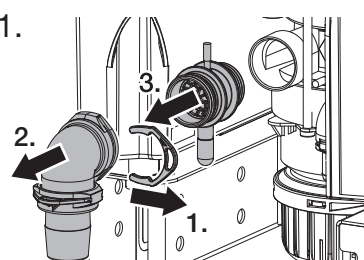

2.



Ready for operation

1

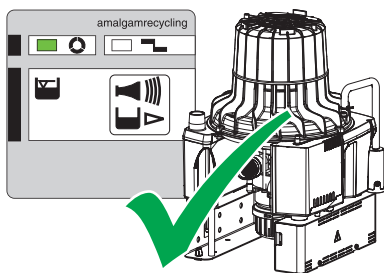

Amalgam collector vessel is 95% full

1

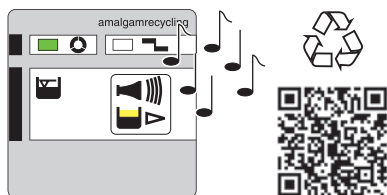

2

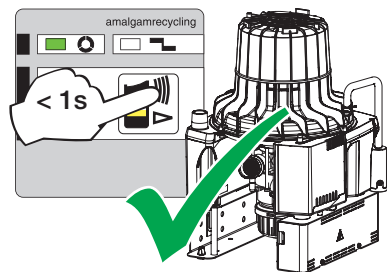

3

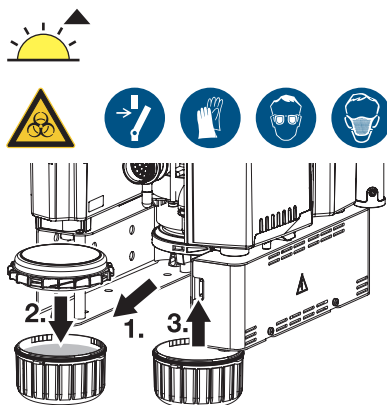

Amalgam collector vessel is 100% full

1



2

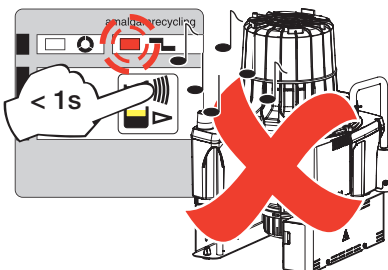

3

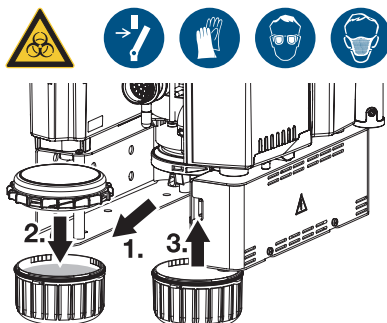

Amalgam collector vessel not in position

1

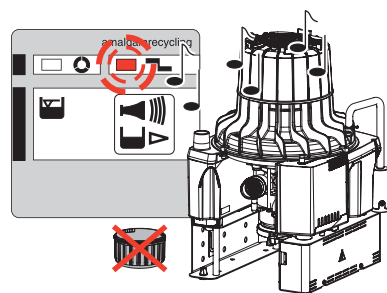

2

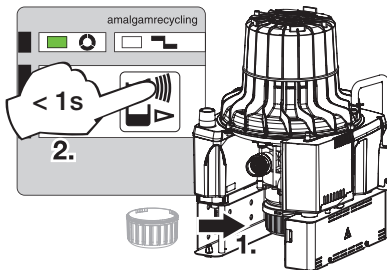

Motor fault

1

